

Assessor's Property Map

41

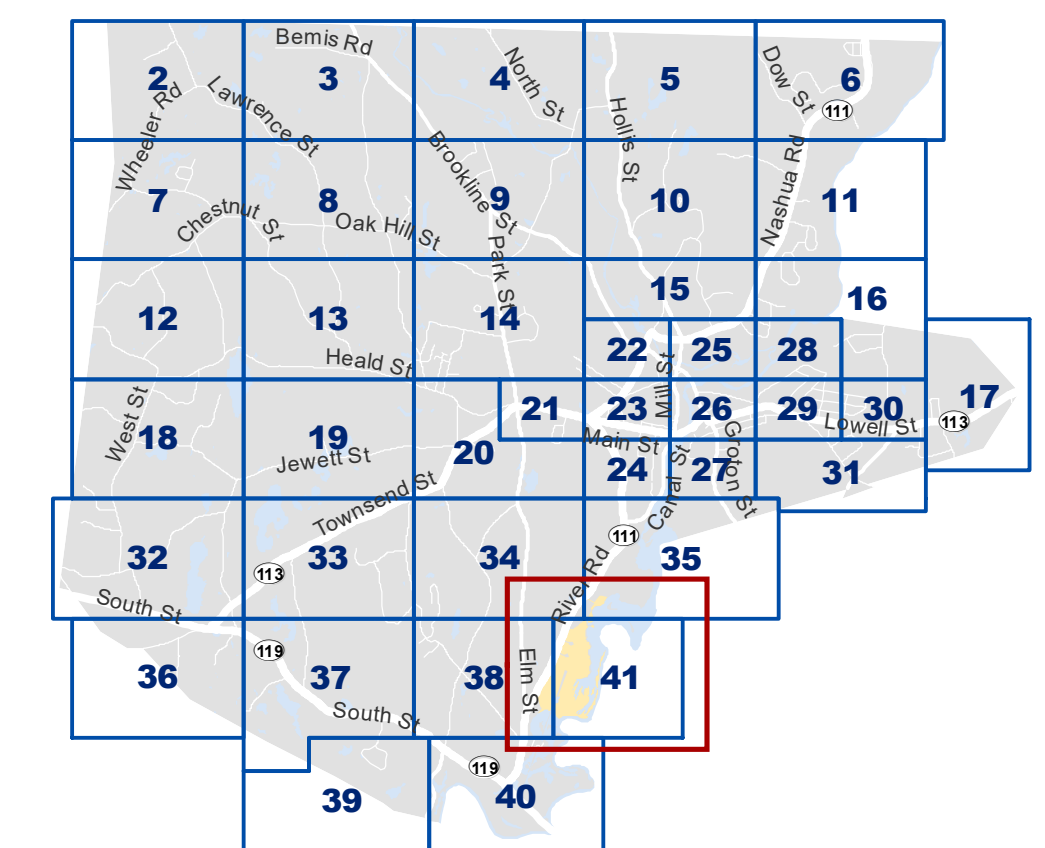

Locus Map



- Parcel Boundary
- Common Ownership Parcel Boundary
- Common Ownership Hook
- Parcel Matching Map Number
- Easement or Conservation Restriction
- Right of Way
- Historic Map Line
- Map Index Grid
- Town Boundary
- Water Feature (approximate)

Parcel Label Key:
 1-1 - Parcel number
 1.5AC - Assessor database acreage
 XYZ - Other note

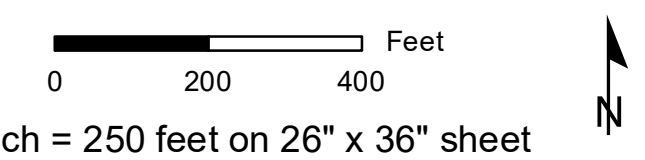

NOTE: Map acreages are derived from the Assessor's database and may include multiple parcels with common ownership (see common ownership boundaries).

Data Sources:
 Town of Pepperell (FY2020 1/10/2019 Patriot extract, public ways); Middlesex South Registry of Deeds; MassGIS (survey town boundaries, building footprints); MassDEP/MassGIS/NMCOG (2005 hydrography); NH GRANIT (New Hampshire roads, towns).

This map is for assessment purposes only. The Town of Pepperell assumes no responsibility for the accuracy of the individual parcels and it is not a valid document for legal description or conveyance. Lot dimensions were compiled from existing assessor's maps and survey based plans. For legal determination please refer to parcel specific deeds or the Town of Pepperell Assessor Office. Water features are based on 2005 MassDEP hydrography data and are for illustration purposes only.

Northern Middlesex Council of Governments (NMCOG) does not make any warranty, expressed or implied, nor assume any legal liability or responsibility for the accuracy, completeness, or usefulness of the Geographic Information System (GIS) Data or any other data provided herein. The GIS data is illustrative only material and should not be considered for any other purpose. The data does not take the place of a professional survey and has no legal bearing on the true shape, size, location, or existence of a geographic feature, property line, or political representation. Any use of this information is at the recipient's own risk.

Produced by:



Northern Middlesex Council of Governments
 40 Church Street, Suite 200
 Lowell, Massachusetts 01852
 978-454-8021 www.nmco.org

Map produced: November 6, 2019

